

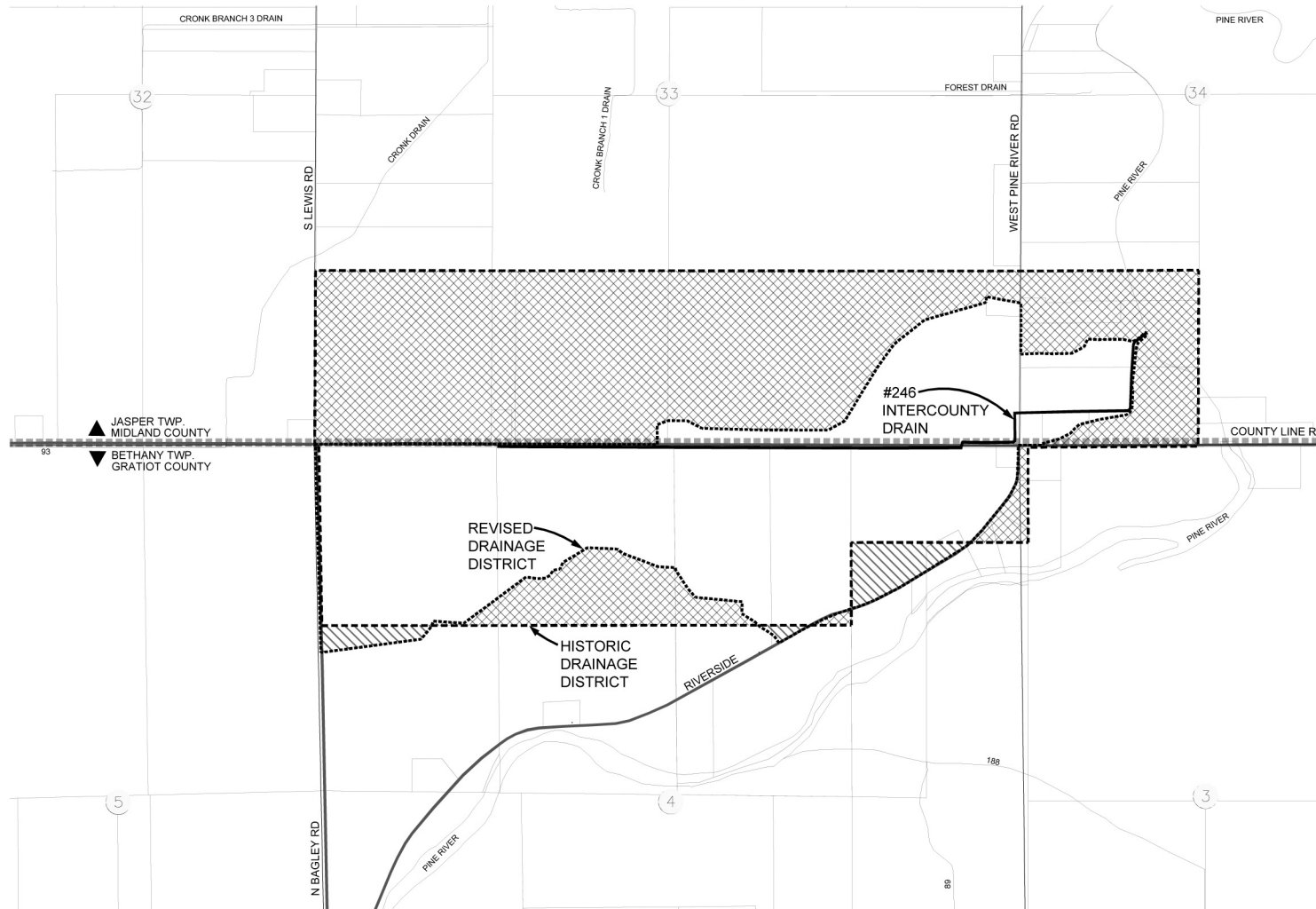

#246 INTERCOUNTY DRAIN

Section 4
T12N, R02W
Bethany Township,
Gratiot County, Michigan

Sections 33-34
T13N, R02W
Jasper Township,
Midland County, Michigan



DRAINAGE DISTRICT INFORMATION:	
HISTORIC DISTRICT:	347.31 ACRES
REVISED DISTRICT:	178.16 ACRES
LANDS ADDED:	9.60 ACRES
LANDS REMOVED:	178.75 ACRES
DRAIN LENGTH:	1.07 MILES

LEGEND

	LANDS REMOVED
	LANDS ADDED
	DRAIN ALIGNMENT (OPEN CHANNEL)
	DRAIN ALIGNMENT (ENCLOSED)
	HISTORIC DRAINAGE DISTRICT BOUNDARY
	REVISED DRAINAGE DISTRICT BOUNDARY
	CITY/VILLAGE LIMITS
	PARCEL LINES
	ROADS
	SECTION LINES
	TOWNSHIP LINE
	COUNTY LINE
	SECTION NUMBERS

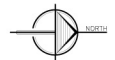

NOT TO SCALE

MAILING MAP

 ENGINEERS & SURVEYORS	2121 3 Mile Rd. NW Walker, MI 49544 Ph: 516-501-7888 www.LREMI.com	PROJECT#: 25-033 DRAWN BY: LGG DATE: JULY, 2025 SHEET: 1/10